

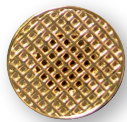

ZA5663



ZA5587



ZA3784 ext diam 16.5 mm

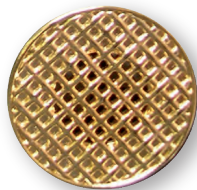

ZA3784 ext diam 26.5 mm

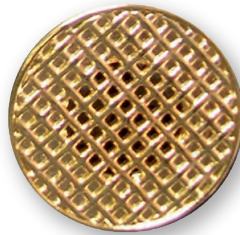

ZA3784 ext diam 33 mm



ZA3784 ext diam 47.5 mm



ZA3783 ext diam 16.5 mm



ZA3785 ext diam 26.5 mm



ZA3785 ext diam 33 mm



ZA3785 ext diam 47 mm



ZA3783 ext diam 16.5 mm



ZA3783 ext diam 26.5 mm



ZA3783 ext diam 33 mm



ZA3783 ext diam 47 mm



ZA3337

SERIE BP OTTONE



Composizione articoli

livello	1	Occhiello e rondella; comprende
livello	2.1	Parte occhiello
livello	2.2	Parte ranella

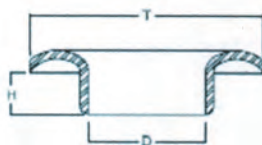

Livello 2.1

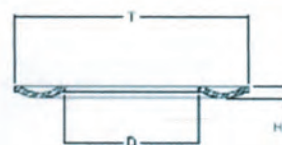

Livello 2.2

Liv	Codice	Descrizione	Materiale	Dimensioni (mm) (3)			Peso nominal e per 1000 pezzi (2)	Confez. standard (1)
				D	T	H		
1	OVCN10170630	OC+RA VL40BP	Ottone				1320	
2.1	OOCB10170630	OCCH. VL40BP	Ottone	9.5	17.0	4.3	950	A RICHIESTA
2.2	ORAN11181230	RAN. R40	Ottone	10.8	17.7	1.1	370	
1	OVCN12030730	OC+RA VL50BP	Ottone				1780	
2.1	OOCB12030730	OCCH. VL50BP	Ottone	12.2	20.0	6.0	1250	A RICHIESTA
2.2	ORAN14221225	RAN. R50	Ottone	13.5	21.8	1.0	530	
1	OVCN13220730	OC+RA VL60BP	Ottone				2050	
2.1	OOCB13220730	OCCH. VL60BP	Ottone	14.0	22.5	5.5	1450	A RICHIESTA
2.2	ORAN16241425	RAN. R60	Ottone	15.7	23.9	1.3	600	
1	OVCN115250740	OC+RA VL70BP	Ottone				2050	
2.1	OOCB115250740	OCCH. VL70BP	Ottone	14.0	25.5	5.5	1450	A RICHIESTA
2.2	ORAN16251940	RAN. R70BP	Ottone	15.7	23.9	1.3	600	
1	OVCN20311040	OC+RA VL90BP	Ottone				6150	
2.1	OOCB20311040	OCCH. VL90BP	Ottone	20.2	31.0	7.5	4300	A RICHIESTA
2.2	ORAN22341940	RAN. R80	Ottone	22.0	34.0	1.5	1850	

SERIE BP OTTONE
DIMENSIONI REALI



VL40BP: Ø 10.0



VL50BP: Ø 12.0



VL60BP: Ø 13.8

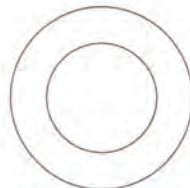

VL70BP: Ø 15.0

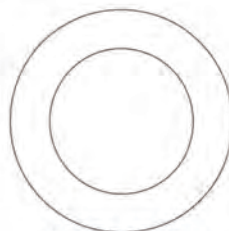

VL90BP: Ø 20.0

AERATORI



Composizione articoli

livello	1	Occhiello e rondella; comprende
livello	2.1	Parte occhiello
livello	2.2	Parte ranella

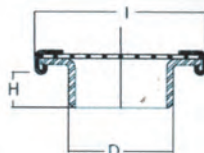

Livello 2.1

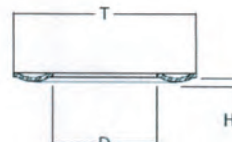

Livello 2.2

OCCHIELLI AERATORE CON BORDO PIATTO

Liv.	Codice	Descrizione	Materiale	Dimensioni (mm) (nota 2)			Peso nominale per 1000 pezzi (g)	Confezione standard (nota 1) (pz.)
				D	T	H		
1	OAPN04080630	OC+RA AER1100P					590	A RICHIESTA
2.1	OAEP04080630	OCCH. AER1100P	Ottone	4.4	7.9	4.4	350	
2.2	ORAN05080725	RAN. R1100	Ottone	4.5	7.5	0.7	140	
1	OAPN05120530	OC+RA AER1130P					760	A RICHIESTA
2.1	OAEP05120530	OCCH. AER1130P	Ottone	5.0	11.9	4.0	640	
2.2	ORAN06100825	RAN. R1130	Ottone	5.8	9.5	0.8	120	
1	OAPN06140630	OC+RA AER1140P					1030	A RICHIESTA
2.1	OAEP06140630	OCCH. AER1140P	Ottone	6.1	13.8	4.0	840	
2.2	ORAN07120825	RAN. R1140	Ottone	6.8	11.8	0.8	190	
1	OAPN07150730	OC+RA AER21P					1540	A RICHIESTA
2.1	OAEP07150730	OCCH. AER21P	Ottone	7.3	14.6	4.9	1320	
2.2	ORAN08130930	RAN. R21	Ottone	7.8	13.0	0.9	220	
1	OABN06120630	OC+RA AER1140B					1030	A RICHIESTA
2.1	OAEB06120630	OCCH. AER1140B	Ottone	6.1	12.4	4.3	840	
2.2	ORAN07120825	RAN. R1140	Ottone	6.8	11.8	0.8	190	
1	OAPB07140630	OC+RA AER21B					1540	A RICHIESTA
2.1	OABN07140630	OCCH. AER21B	Ottone	7.3	14.4	5.1	1320	
2.2	ORAN08130930	RAN. R21	Ottone	7.8	13.0	0.9	220	
1	OABN08160730	OC+RA AER30B					1640	A RICHIESTA
2.1	OAEB08160730	OCCH. AER30B	Ottone	8.0	16.6	4.5	1400	
2.2	ORAN09150830	RAN. R30	Ottone	8.3	14.6	0.8	240	
1	OABN10210930	OC+RA AER40B					2720	A RICHIESTA
2.1	OAEB10210930	OCCH. AER40B	Ottone	9.8	21.3	6.7	2350	
2.2	ORAN11181230	RAN. R40	Ottone	10.8	17.7	1.1	370	
1	OABN12241030	OC+RA AER50B					3430	A RICHIESTA
2.1	OAEB12241030	OCCH. AER50B	Ottone	12.4	23.8	6.3	2900	
2.2	ORAN14221225	RAN. R50	Ottone	13.5	21.8	1.0	530	

SCHEMA DIMENSIONI REALI AERATORI BORDO PIATTO



AER1100P



AER1130P



AER1140P



AER21P

SCHEMA DIMENSIONI REALI AERATORI BORDO ARROTONDATO



AER1140B



AER21B



AER30B

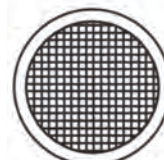

AER40



AER50B

SERIE ELLISSE



Composizione articoli

livello	1	Occhiello e rondella; comprende
livello	2.1	Parte occhiello
livello	2.2	Parte ranella

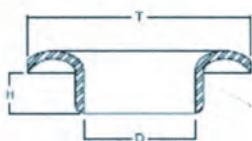

Livello 2.1

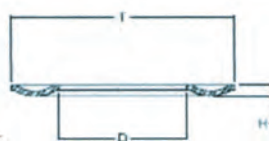

Livello 2.2

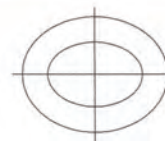

Questa linea di occhielli è protetta da brevetto

Liv.	Codice	Descrizione	Materiale	Dimensioni (mm) (3)			Peso nominale per 1000 pezzi (2)	Confez. standard (1)
				D	T	H		
1	OELN04506502	OC+RA EL45/65	Ottone				420	1000
2.1	OOCN04506502	OCCH. EL45/65	Ottone	4.5X6.5	9X11	4.0	300	(1000)
2.2	ORAE04506501	RAN. EL45/65	Ottone	4.6X6.6	9X11	0.8	120	(1000)
1	OELN06509505	OC+RA EL65/95	Ottone				530	1000
2.1	OOCN06509505	OCCH. EL65/95	Ottone	6.5X9.5	12X15	4.3	350	(1000)
2.2	ORAE06509501	RAN. EL65/95	Ottone	6.6X9.6	12X15	0.8	180	(1000)
1	OELN09013007	OC+RA EL90/130	Ottone				1260	1000
2.1	OOCN09013007	OCCH. EL90/130	Ottone	9X13	16.5X21	4.2	700	(1000)
2.2	ORAE09013001	RAN. EL90/130	Ottone	9.1X13.1	16.5X21	1.0	560	(1000)
1	OELN11016009	OC+RA EL110/160	Ottone				1800	1000
2.1	OOCN11016009	OCCH. EL110/160	Ottone	11X16	20X25	5.8	1200	(1000)
2.2	ORAE11016001	RAN. EL110/160	Ottone	11.1X16.1	20X25	1.1	600	(1000)
1	OELN13021011	OC+RA EL130/210	Ottone				2800	1000
2.1	OOCN13021011	OCCH. EL130/210	Ottone	13X21	24X32	5.8	1750	(1000)
2.2	ORAE13021001	RAN. EL130/210	Ottone	13.2X21.2	24X32	1.2	1050	(1000)
1	OELN18025015	OC+RA EL180/250	Ottone				5000	500
2.1	OOCN18025015	OCCH. EL180/250	Ottone	18X25	31X38	6.5	3000	(500)
2.2	ORAE18025002	RAN. EL180/250	Ottone	18.2X25.2	31X38	1.4	2000	(500)

SERIE ELLISSE
DIMENSIONE REALE



EL45/65: Ø 4.5 X 6.5



EL65/95: Ø 6.5 X 9.5



EL90/130: Ø 9.0 X 13.0

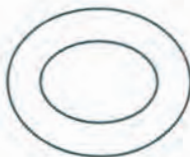

EL110/160: Ø 11.0 X 16.0

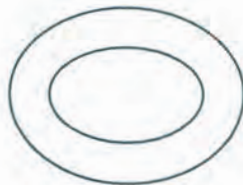

EL130/210: Ø 13.0 X 21.0



EL180/250: Ø 18.0 X 25.0

SERIE EXTRA LARGE



Composizione articoli

livello	1	Occhiello e rondella; comprende
livello	2.1	Parte occhiello
livello	2.2	Parte ranella

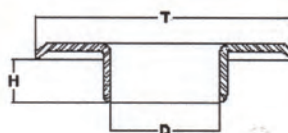

Livello 2.1

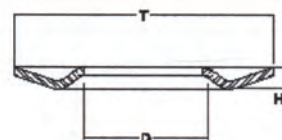

Livello 2.2

Liv	Codice	Descrizione	Materiale	Dimensioni (mm) (3)			Peso nominal e per 1000 pezzi (2)	Confez. standard (1)
				D	T	H		
1	OVXX06170430	OC+RA VL240XLP	Ottone				1100	A RICHIESTA
2.1	OOCX06170430	OCCH. VL240XLP	Ottone	6.0	17.0	4.2	650	
2.2	ORAX0716093	RAN. R240XLP	Ottone	7.0	16.0	0.9	450	
1	OVXX10250530	OC+RA VL40XLP	Ottone				2300	A RICHIESTA
2.1	OOCX10250530	OCCH. VL40XLP	Ottone	9.9	25.0	4.9	1350	
2.2	ORAX10241230	RAN. R40XLP	Ottone	10.7	24.0	1.2	950	
1	OVXX14330640	OC+RA VL60XLP	Ottone				5500	A RICHIESTA
2.1	OOCX14330640	OCCH. VL60XLP	Ottone	13.9	33.0	6.1	3200	
2.2	ORAX15321240	RAN. R60XLP	Ottone	14.6	32.0	1.2	2300	

SERIE EXTRA LARGE

VERSIONE LISCIA



VERSIONE CON SEDE PER SMALTO O GLITTER



VERSIONE CON SMALTO O GLITTER



DIMENSIONE REALE



VL240XLP: Ø 6.0

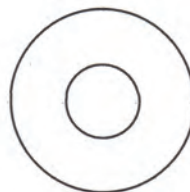

VL40XLP: Ø 10.0

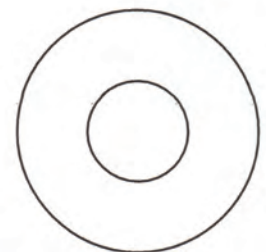

VL60XLP: Ø 14.0

SERIE TESTA BOMBATA



Composizione articoli

livello	1	Occhiello e rondella; comprende
livello	2.1	Parte occhiello
livello	2.2	Parte ranella

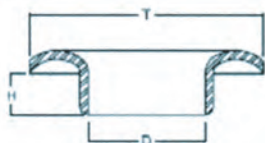

Livello 2.1

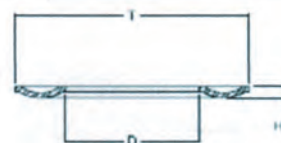

Livello 2.2

Liv.	Codice	Descrizione	Materiale	Dimensioni (mm) (3)			Peso nominale per 1000 pezzi (2) (g)	Confez. standard (1) (pz.)
				D	T	H		
1	OVBS06140530	OC+RA VL240BS	Ottone				840	1000
2.1	OOCB06140530	OCCH. VL240BS	Ottone	6.2	14	4.0	500	(1000)
2.2	ORAS14141030	RAN. R240S BIFACCIALE	Ottone	7.1	14	1.0	340	(1000)
1	OVBN07130630	OC+RA VL21B	Ottone				720	1000
2.1	OOCB07130630	OCCH. VL21B	Ottone	7.3	13.0	4.9	500	(1000)
2.2	ORAN08130930	RAN. R21	Ottone	7.8	13.0	0.9	220	(1000)
1	OVBN07130430	OC+RA VL21B H4	Ottone				610	
2.1	OOCB07130430	OCCH. VL21B	Ottone	7.3	13.0	3.6	370	A RICHIESTA
2.2	ORAN08130930	RAN. R21	Ottone	7.8	13.0	0.9	240	
1	OVBN08150630	OC+RA VL30B	Ottone				860	1000
2.1	OVBN08150630	OCCH. VL30B	Ottone	7.8	15.0	4.7	600	(1000)
2.2	ORAN09150830	RAN. R30	Ottone	8.3	14.6	0.8	260	(1000)
1	OVBN10200630	OC+RA VL40B	Ottone				1320	1000
2.1	OOCB10200630	OCCH. VL40B	Ottone	9.5	19.9	4.3	950	(1000)
2.2	ORAN11181230	RAN. R40	Ottone	10.8	17.7	1.1	370	(1000)
1	OVBS10200630	OC+RA VL40BS	Ottone				1750	1000
2.1	OOCB10200630	OCCH. VL40B	Ottone	9.5	19.9	4.3	950	(1000)
2.2	ORAS11201550	RAN. R40S BIFACCIALE	Ottone	10.5	20.1	1.3	800	(1000)
1	OVBN12230730	OC+RA VL50B	Ottone				1780	1000
2.1	OOCB12230730	OCCH. VL50B	Ottone	12.2	22.5	6.0	1250	(1000)
2.2	ORAN14221225	RAN. R50	Ottone	13.5	21.8	1.0	530	(1000)
1	OVBS12230730	OC+RA VL50BS	Ottone				1950	1000
2.1	OOCB12230730	OCCH. VL50B	Ottone	12.2	22.5	6.0	1250	(1000)
2.2	ORAS13221330	RAN. R50S BIFACCIALE	Ottone	13.5	22.4	1.2	700	(1000)

SERIE TESTA BOMBATA

Liv.	Codice	Descrizione	Materiale	Dimensioni (mm) (3)			Peso nominale per 1000 pezzi (2) (g)	Confez. standard (1) (pz.)
				D	T	H		
1	OVBN13260730	OC+RA VL60B	Ottone				2050	1000
2.1	OOCB13260730	OCCH. VL60B	Ottone	14.0	25.5	5.5	1450	(1000)
2.2	ORAN16241425	RAN. R60	Ottone	15.7	23.9	1.3	600	(1000)
1	OVBS13260730	OC+RA VL60BS	Ottone				2300	1000
2.1	OOCB13260730	OCCH. VL60B	Ottone	14.0	25.5	5.5	1450	(1000)
2.2	ORAS16261330	RAN. R60S BIFACCIALE	Ottone	15.7	23.9	1.3	850	(1000)
1	OVBN15260730	OC+RA VL70B	Ottone				4200	1000
2.1	OOCB15260730	OCCH. VL70B	Ottone	15.9	28.1	5.9	2700	(1000)
2.2	ORAN18291940	RAN. R70	Ottone	17.3	29.0	1.5	1500	(1000)
1	OVBN15260730	OC+RA VL70BS	Ottone				4200	1000
2.1	OOCB15260730	OCCH. VL70B	Ottone	15.9	28.1	5.9	2700	(1000)
2.2	ORAS17281440	RAN. R70S BIFACCIALE	Ottone	17.4	28.4	1.4	1500	(1000)
1	OVBN20381040	OC+RA VL90B	Ottone				6150	
2.1	OOCB20381040	OCCH. VL90B	Ottone	20.2	38.0	7.5	4300	A RICHIESTA
2.2	ORAN22341940	RAN. R80	Ottone	22.0	34.0	1.5	1850	
1	OVBS20381040	OC+RA VL90BS	Ottone				7300	500
2.1	OOCB20381040	OCCH. VL90B	Ottone	20.2	38.0	7.5	4300	(500)
2.2	ORAS21382040	RAN. R90S BIFACCIALE	Ottone	21.7	38.0	1.7	3000	(500)
1	OVBS30521050	OC+RA VL105BS	Ottone				14100	250
2.1	OOCB30521050	OCCH. VL105B	Ottone	30.0	52.0	7.5	9200	(250)
2.2	ORAS31522540	RAN. R105S BIFACCIALE	Ottone	33.0	52.0	2.3	4900	(250)

SERIE TESTA BOMBATA

DIMENSIONE REALE

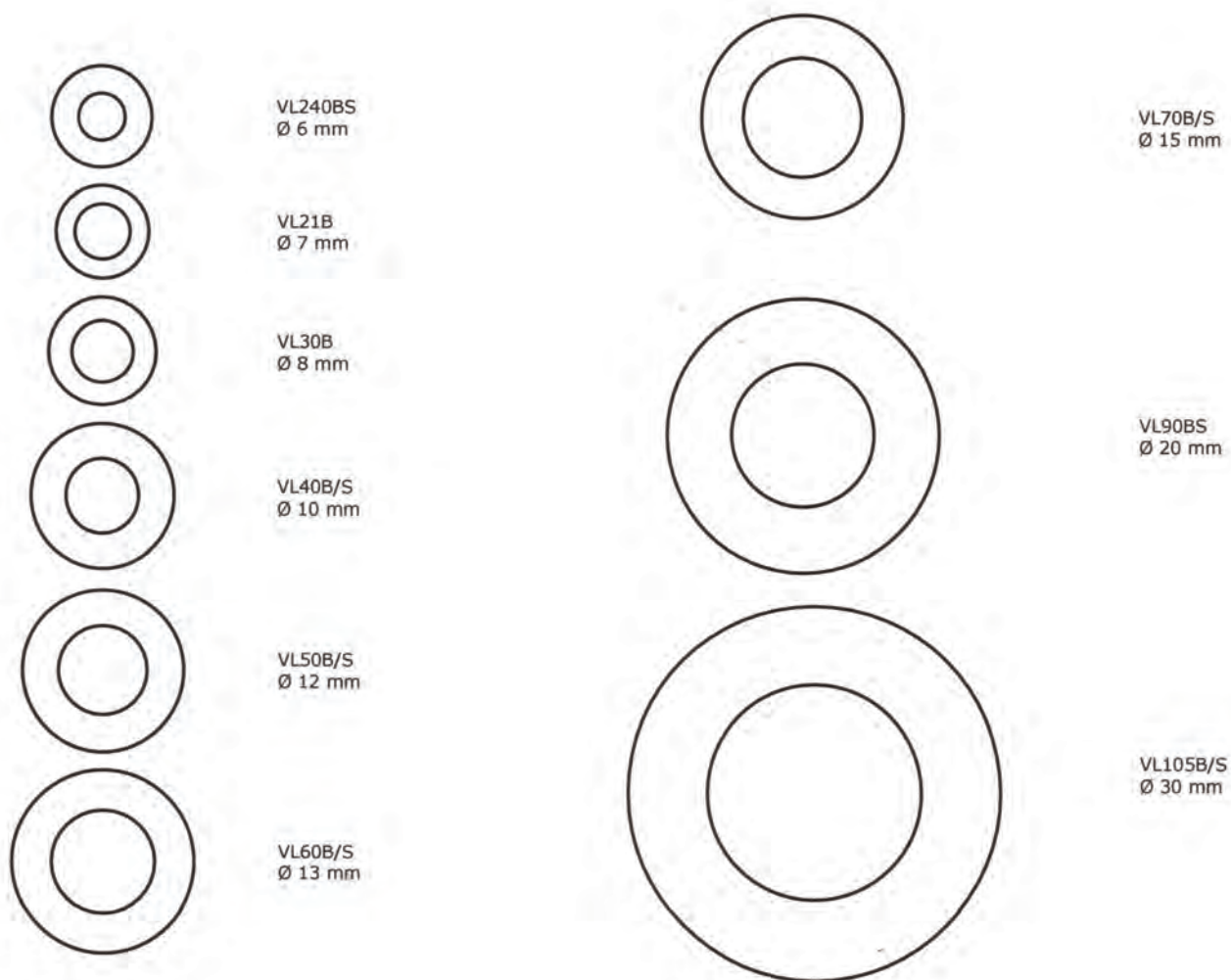

SERIE TESTA PIATTA



Composizione articoli

livello	1	Occhiello e rondella; comprende
livello	2.1	Parte occhiello
livello	2.2	Parte ranella

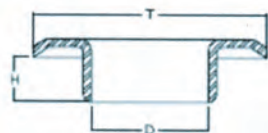

Livello 2.1









Livello 2.2

Liv	Codice	Descrizione	Materiale	Dimensioni (mm) (nota 2)			Peso nominal e per 1000 pezzi (g)	Confezion e standard (nota 1) (pz.)
				D	T	H		
1	OVPS04090530	OC+RA VL210TPS	Ottone				380	1000
2.1	OOCPO4090530	OCCH. VL210TP	Ottone	4.0	9.5	3.6	260	(1000)
2.2	ORAS05100730	RAN. R210S BIFACCIALE	Ottone	4.6	9.5	0.7	120	(1000)
1	OVPS05120530	OC+RA VL230TPS	Ottone				550	1000
2.1	OOCPO5120530	OCCH. VL230TP LUCIDO	Ottone	4.9	12	4.4	360	(1000)
2.2	ORAS06120830	RAN. R230S BIFACCIALE	Ottone	5.7	12	0.9	190	(1000)
1	OVPS05120430	OC+RA VL230TPS/4	Ottone				490	
2.1	OOCPO5120430	OCCH. VL230TP/4	Ottone	4.9	12	3.5	300	A RICHIESTA
2.2	ORAS06120830	RAN. R230S BIFACCIALE	Ottone	5.7	12	0.9	190	
1	OVPS06140530	OC+RA VL240TPGS	Ottone				840	1000
2.1	OOCPO6140530	OCCH. VL240TPG	Ottone	6.2	14	4.0	500	(1000)
2.2	ORAS14141030	RAN. R240S BIFACCIALE	Ottone	7.1	14	1.0	340	(1000)
1	OVPN08150630	OC+RA VL30TP	Ottone				870	1000
2.1	OOCPO8150630	OCCH. VL30TP	Ottone	7.9	15.0	5.0	630	(1000)
2.2	ORAN09150830	RAN. R30	Ottone	8.3	14.6	0.8	240	(1000)
1	OVPN08150530	OC+RA VL30TP/4	Ottone				740	
2.1	OOCPO8150530	OCCH. VL30TP/4	Ottone	7.9	15.0	3.8	500	A RICHIESTA
2.2	ORAN09150830	RAN. R30	Ottone	8.3	14.6	0.8	240	
1	OVPN10190630	OC+RA VL40TPP	Ottone				1140	1000
2.1	OOCPO10190630	OCCH. VL40TPP	Ottone	9.7	18.0	4.7	770	(1000)
2.2	ORAN11181230	RAN. R40	Ottone	10.8	17.7	1.1	370	(1000)
1	OVPN10200630	OC+RA VL40TPG	Ottone				1320	1000
2.1	OOCPO10200630	OCCH. VL40TPG	Ottone	9.6	19.9	4.50	950	(1000)

SERIE TESTA PIATTA

DIMENSIONE REALE

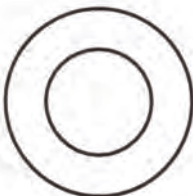
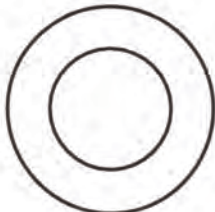
	VL210TPS Ø 4mm
	VL230TPS Ø 5 mm
	VL240TPGS Ø 6 mm
	VL30TP Ø 8 mm
	VL40TPP Ø 10 mm
	VL40TPG/S Ø 10 mm
	VL50TP/S Ø 12 mm
	VL60TP/S Ø 13 mm
	VL70TP/S Ø 15 mm

SERIE TESTA PIATTA

DIMENSIONE REALE

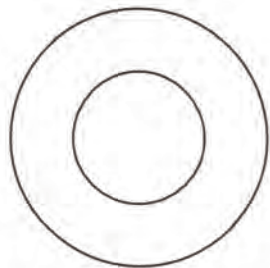

VL80TP
Ø 18 mm

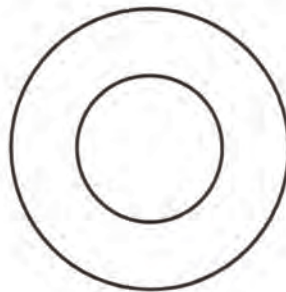

VL90TPS
Ø 20 mm

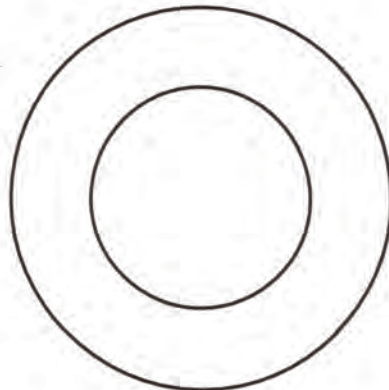

VL105TPS
Ø 30 mm

SERIE TESTA PIATTA

Liv	Codice	Descrizione	Materiale	Dimensioni (mm) (nota 2)			Peso nominal e per 1000 pezzi (g)	Confezion e standard (nota 1) (pz.)
				D	T	H		
2.2	ORAN11181230	RAN. R40	Ottone	10.8	17.7	1.1	370	(1000)
1	OVPS10200630	OC+RA VL40TPGS	Ottone				1750	1000
2.1	OCCP10200630	OCCH. VL40TPGS	Ottone	9.6	19.9	4.5	950	(1000)
2.2	ORAS11201550	RAN. R40S BIFACCIALE	Ottone	10.5	20.1	1.3	800	(1000)
1	OVPN12230630	OC+RA VL50TP	Ottone					1000
2.1	OCCP12230630	OCCH. VL50TP	Ottone	12.2	22.5	5.2	1200	(1000)
2.2	ORAN14221225	RAN. R50	Ottone	13.5	21.8	1.0	530	(1000)
1	OVPS12230630	OC+RA VL50TPS	Ottone					1000
2.1	OCCP12230630	OCCH. VL50TP	Ottone	12.2	22.5	5.2	1200	(1000)
2.2	ORAS13221330	RAN. R50S BIFACCIALE	Ottone	13.5	22.4	1.2	700	(1000)
1	OVPN13260730	OC+RA VL60TP	Ottone				2050	1000
2.1	OCCP13260730	OCCH. VL60TP	Ottone	14.0	25.5	5.5	1450	(1000)
2.2	ORAN16241425	RAN. R60	Ottone	15.7	23.9	1.3	600	(1000)
1	OVPS13260730	OC+RA VL60TPS	Ottone				2300	1000
2.1	OCCP13260730	OCCH. VL60TP	Ottone	14.0	25.5	5.5	1450	(1000)
2.2	ORAS16261330	RAN. R60S BIFACCIALE	Ottone	15.7	23.9	1.3	850	(1000)
1	OVPN15280840	OC+RA VL70TP	Ottone				4200	1000
2.1	OCCP15280840	OCCH. VL70TP	Ottone	15.9	28.1	6.2	2700	(1000)
2.2	ORAN18291940	RAN. R70	Ottone	17.3	29.0	1.5	1500	(1000)
1	OVPS15280840	OC+RA VL70TPS	Ottone				4200	1000
2.1	OCCP15280840	OCCH. VL70TP	Ottone	15.9	28.1	6.2	2700	(1000)
2.2	ORAS17281440	RAN. R70S BIFACCIALE	Ottone	17.4	28.4	1.4	1500	(1000)
1	OVPN18350940	OC+RA VL80TP	Ottone				5600	
2.1	OCCP18350940	OCCH. VL80TP	Ottone	18.2	35.0	7.7	3750	A RICHIESTA
2.2	ORAN22341940	RAN. R80	Ottone	22.0	34.0	1.5	1850	
1	OVPN20381040	OC+RA VL90TP	Ottone				6150	
2.1	OCCP20381040	OCCH. VL90TP	Ottone	20.2	38.0	7.5	4300	A RICHIESTA
2.2	ORAN22341940	RAN. R80	Ottone	22.0	34.0	1.5	1850	
1	OVPS20381040	OC+RA VL90TPS	Ottone				7300	500
2.1	OCCP20381040	OCCH. VL90TP	Ottone	20.2	38.0	7.5	4300	(500)
2.2	ORAS21382040	RAN. R90S BIFACCIALE	Ottone	21.7	38.0	1.7	3000	(500)
1	OVPS30521050	OC+RA VL105TPS	Ottone				14100	250
2.1	OCCP30521050	OCCH. VL105TP	Ottone	30.0	52.0	8.3	9200	(250)
2.2	ORAS31522540	RAN. R105S BIFACCIALE	Ottone	33.0	52.0	2.3	4900	(250)

SERIE CH



Composizione articoli

livello	1	Occhiello e rondella; comprende
livello	2.1	Parte occhiello
livello	2.2	Parte ranella

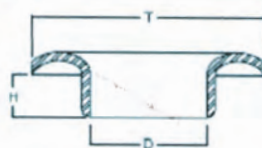

Livello 2.1

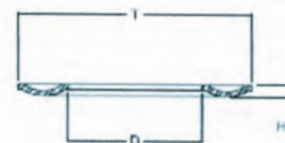

Livello 2.2

Liv.	Codice	Descrizione	Materiale	Dimensioni (mm) (3)			Peso nominale per 1000 pezzi (2) (g)	Confez. standard (1) (pz.)
				D	T	H		
1	OVSN08110630	OC+RA VL30CH	Ottone				660	A RICHIESTA
2.1	OOCN08110630	OCCH. VL30CH	Ottone	7.9	11.0	5.0	420	
2.2	ORAN09150830	RAN. R30	Ottone	8.3	14.6	0.8	240	
1	OVSN10145530	OC+RA VL40CH	Ottone				800	A RICHIESTA
2.1	OOCN10145530	OCCH. VL40CH	Ottone	9.5	13.5	5.0	430	
2.2	ORAN11181230	RAN. R40	Ottone	10.8	17.7	1.1	370	
1	OVSN14205530	OC+RA VL55CH	Ottone				1610	A RICHIESTA
2.1	OOCN14205530	OCCH. VL55CH	Ottone	14.5	20.0	5.0	840	
2.2	ORAN15225050	RAN. R50CH PIATTA	Ottone	15.3	22.0	0.5	770	
1	OVSN15227040	OC+RA VL70CH	Ottone				2100	A RICHIESTA
2.1	OOCN15227040	OCCH. VL70CH	Ottone	15.8	21.7	7.2	1500	
2.2	ORAN16251940	RAN. R70BP	Ottone	15.7	23.9	1.3	600	
1	OVSN20275840	OC+RA VL90CH	Ottone				4350	A RICHIESTA
2.1	OOCN20275840	OCCH. VL90CH	Ottone	20.2	27.5	8.5	2500	
2.2	ORAN22341940	RAN. R80	Ottone	22.0	34.0	1.5	1850	

SERIE CH

DIMENSIONE REALE



VL30CH: Ø 8.0



VL40CH: Ø 10.0

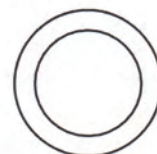

VL55CH: Ø 14.5

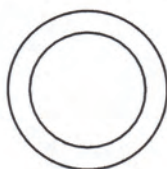

VL70CH: Ø 15.8

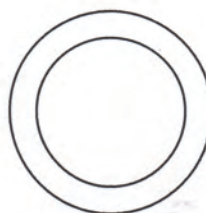

VL90CH: Ø 20.0

FOTOGRAFIE CON ESEMPI DI TRATTAMENTI SUPERFICIALI



OCCHIELLO 30CH
FINITURA: NICHEL LUX ®



OCCHIELLO 40CH
FINITURA: NICHEL LUX ®



OCCHIELLO 55CH
FINITURA: NICHEL LUX ®



OCCHIELLO 70CH
FINITURA: NICHEL LUX ®



OCCHIELLO 90CH
FINITURA: NICHEL LUX ®